

2418TJ-XX

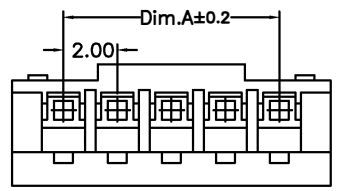

2418HJ-XX

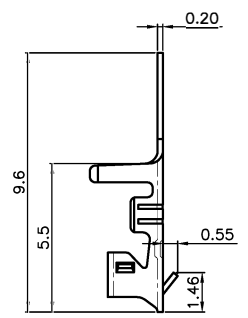

SECTION A-A

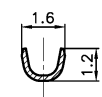

SECTION B-B

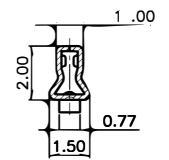

SECTION C-C

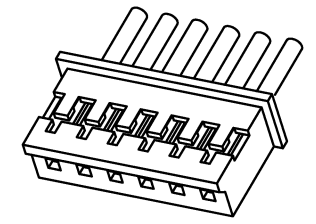

Specifications:

Current rating: 2.0A AC/DC
 Voltage rating: 125V AC/DC
 Contact resistance: 20m ohm. Max
 Insulation resistance: 1000M ohm. Min
 Withstanding voltage: 500V AC/minute
 Operating temperature range: -40°C ~ +85°C
 Material:
 Insulator: Nylon 66 (UL94V-0)
 Color: White
 Contact: Phosphor Bronze
 Plated: Tin Plated
 Applicable Wire: Awg #24 ~ #28
 How To Order:
 2418HJ-XX

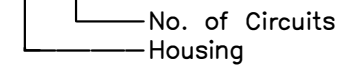

Dimension:

Circuits	Dimension:		Circuits	Dimension:	
	A	B		A	B
02	2.00	5.80	11	20.00	23.80
03	4.00	7.80	12	22.00	25.80
04	6.00	9.80	13	24.00	27.80
05	8.00	11.80	14	26.00	29.80
06	10.00	13.80	15	28.00	31.80
07	12.00	15.80	16	30.00	33.80
08	14.00	17.80	17	32.00	35.80
09	16.00	19.80	18	34.00	37.80
10	18.00	21.80			

RoHS Compliant

GENERAL TOLERANCE:
 .X = ±0.20
 .XX = ±0.15

UNIT: MM
 SCALE: 1:1
 SHEET: 1 / 1
 PROJECTION:

SEMICONDUCTORES Y COMPONENTES

DESCRIPTION: 2.0mm Wire To Board Housing

PART NO: 2418HJ-XX

SIZE
A4